

HOME DESIGN EXPO 2014



Ferreiras
Tile + Bathroom

Out of the Ordinary™



THE HILLS
GAME RESERVE LIFESTYLE ESTATE

HOME DESIGN

02



CAPRICORN CIVILS
CIVIL ENGINEERING BUILDING DESIGN
CONSTRUCTION PROJECT MANAGEMENT

▶ **ARCHITECT**
MTWA Architecture

▶ **BUILDER**
Capricorn Civils

▶ **SPECS**
- 330m² area house
- Open plan kitchen and lounge
- Covered patios and pool
- 2x en-suites bedrooms
- Private guest suite
- Double garages

HOME DESIGN

02



HOME DESCRIPTION

A house set on one of the highest points of The Hills landscape. A site opening up to a green belt meant that one had to be aware of the exposure that the house has both on the entrance and entertainment areas. The open plan layout has the dining and lounging areas freely opening up to the exterior thus connecting to the visually in-flowing landscapes. North facing bedrooms are flooded by the natural light while offering endless views from the top of the hill.

These free flowing spaces are clothed by rustic and raw wall surfaces such as natural timber, stone and earth toned colours. These raw building components are countered by extensive glazing surfaces one of which extends from the water feature up to the first floor spaces and also folding around the main staircase. A natural timber screen panel leads one from the adjoining road right up to the water feature at the main house entrance.

Large glazing panels draw the natural Pretoria sun into the living spaces. This light is then trapped in by the presence of automated blinds thus keeping the house naturally heated deep into winter nights. The deep covered balconies also keep the spaces cool in summer.

All these elements combined produce a well-balanced home both in living and visual experiences.



▶ **NORTH FACING BED-ROOMS ARE FLOODED BY NATURAL LIGHT**

INNOVATION & GREEN DESIGN

Water harvesting is becoming more and more important in South Africa as hints of national water shortages are surfacing.

Gutters collect rainwater from the sloped roofs down to the underground water tanks which in turn supplies this rainwater as irrigation. This is one basic but effective green practices applied in this building.

Under floor heating is generated by a heat pump system thus taking away dependency from the grid.

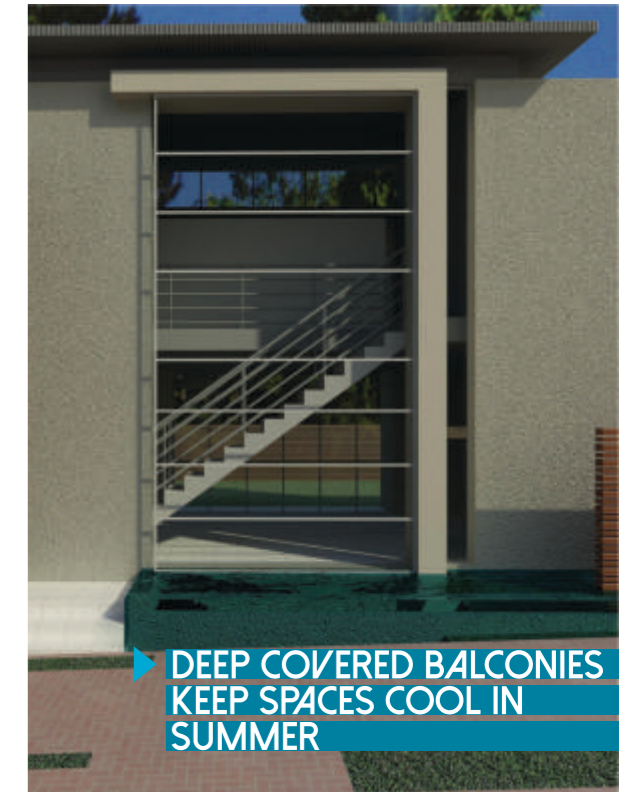

▶ **DEEP COVERED BALCONIES KEEP SPACES COOL IN SUMMER**



MTWA ARCHITECTURE

MTWA is a young vibrant practice with professionals always looking for the opportunity to create sustainable architectural forms that relate to the given contexts and situations.

Our design is informed by economical, environmental and social sustainability.

Mostly involved in residential architecture, we have been fortunate in having the opportunity to apply skills in estates that promote residential architecture that make full use of natural materials and elements thus creating sustainable and relevant modern homes.

Some of these being Waterfall, Serengeti and The Hills. These are homes that have met our client's expectations and have therefore fuelled the word of mouth aspect of the practice. With consistency, the practice can only move upwards.

CAPRICORN CIVILS

Capricorn Civils are a family owned business that has delivered outstanding projects over the past 15 years.

Our Projects range from top end residential building projects to civil engineering- and agriculture projects. Capricorn Civils are committed to the highest ethical- standards in all that we do. We strive to deliver the highest quality of construction to ensure the satisfaction of our clients at fair and market related prices. We also maintain high levels of professionalism, integrity, honesty and fairness in our relationships with our suppliers, sub-contractors, professional associates and- customers. Attention to detail and specialist finishing's help us complete each project with success. Timelines are kept, deadlines are met and the budget is set

NHRC Registered, CIDB registered and current ratings of 4CE and 5GB.

CONTACT

▶ **MTWA Architecture**
www.mtwa.co.za
Paul Mtw
design@mtwa.co.za
072 252 6369

▶ **Capricorn Civils**
www.capricorncivils.co.za
Chrisjan Swanepoel
chrisjan@capricorncivils.co.za
076 756 4106



This home was specifically designed to fit into this prestigious lifestyle estate. It conforms to the Hills uniquely South African style of architecture which embraces "green living" and open space.

For more information on this estate or to arrange an exclusive meeting please feel free to contact one of our representatives.

Augustine: 083 635 5215
Les: 084 075 3270



THE HILLS
GAME RESERVE LIFESTYLE ESTATE
HOME DESIGN
02

SPONSORS



HOME DESIGN EXPO 2014

- ▶ **Super Slabs**
www.superslabs.co.za
Kayle Ramathan
sales@superslabs.co.za
011 791 4554
- ▶ **SELATI GROUP roofing**
www.selatigroup.co.za
Dirk Joubert
dirk@selatigroup.co.za
073 377 4622
- ▶ **ALUFAST Glass & Aluminium**
www.alufast.co.za
Terence Wright
terence.alufast@telkomsa.net
082 338 4376
- ▶ **Union tiles**
www.uniontiles.co.za
-
info@uniontiles.co.za
012 643 0121
- ▶ **Africote Coatings**
www.africote.co.za
Retha van der Walt
africotelim@gmail.com
079 820 4724
- ▶ **Bella Bathrooms**
www.bellabathrooms.co.za
Zerona Swanepoel
zerona@bellabathrooms.co.za
011 262 3731



www.century.co.za