

HOME DESIGN EXPO 2014



Ferreiras
Tile + Bathroom

Out of the Ordinary™



THE HILLS
GAME RESERVE LIFESTYLE ESTATE

HOME DESIGN

08



MCL CONSTRUCTION

▶ ARCHITECT

Engela van Antwerpen

▶ BUILDER

Michael Lester

▶ SPECS

- House size 305m²
- Main bedroom-suite & study
- Open plan kitchen-dining
- Study nook
- Kitchen & Scullery
- Pantry
- Staff Quarters
- Double Garage
- Entertainment terrace
- Swimming pool

HOME DESIGN

08



HOME DESCRIPTION

Notice the unique design of the combination of modern with the farm style cottage, with an elemental experience. The large glass facades and stackable glass doors enhances the interconnectivity of the inside and outside, framing the serene environment of the estate. Low maintenance living is a key driver towards the house design. The unique design to combine modern with a farm style cottage style, unassuming but special and completely different. Greeted by a modern cube with a lush grass roof and an exaggerated west façade with pavement that is alive with foliage. Entering the house is un-obscured, open and inviting, leading down with steps at each area with the natural fall of the landscape. The outside entertainment area is located adjacent to the open area and kitchen, with easy access to enjoy braais in summer. Usage of space is an important design criterion, shunning away from too many compartmentalization of rooms and corridors. Within the main bedroom is a study nook and covered balcony, allowing for a lovely setting to read and enjoy a beverage whilst basking in the morning sun. The second bedroom opens onto a small balcony area; just enough to get some fresh air and the third bedroom has the luxury of having a little garden balcony, for which the grassed roof terrace provides. To accommodate the fall of the natural ground, terraced areas are introduced, these can either be paved areas or landscaped with indigenous plants. A deck area surrounded with pavers, leading to the swimming pool made from composite wood. The house has no defined style or expected finish, each area has its own personality settling in time with the unique features, aging with beauty. A timeless design style.



THE HILLS
GAME RESERVE LIFESTYLE ESTATE

This home was specifically designed to fit into this prestigious lifestyle estate. It conforms to the Hills uniquely South African style of architecture which embraces "green living" and open space.

For more information on this estate or to arrange an exclusive meeting please feel free to contact one of our representatives.

Augustine: 083 635 5215

Les: 084 075 3270



▶ UNASSUMING BUT SPECIAL AND COMPLETELY DIFFERENT

INNOVATION & GREEN DESIGN

Design and simulation go into the planning phase to ensure that the most of the natural heat and light is used. Combining the use of plaster, face bricks, stone and concrete ensures lower maintenance. Services from the house are grouped around a central area in the back yard. This ensures minimal space for services, no visible pipes, and allowing for simple connection to grey water filtering and harvesting. Gas is installed for use of the stove and braai unit. The first floor has water pipe under floor heating, with heating controlled per room, ensuring energy not wasted on other areas other than desired. The orientation of the house with the long axes is north-south, utilizing the most of what nature can provide with natural elements. The garden is simple, with a large lawn and many indigenous trees, adding to the low maintenance and a water wise garden.

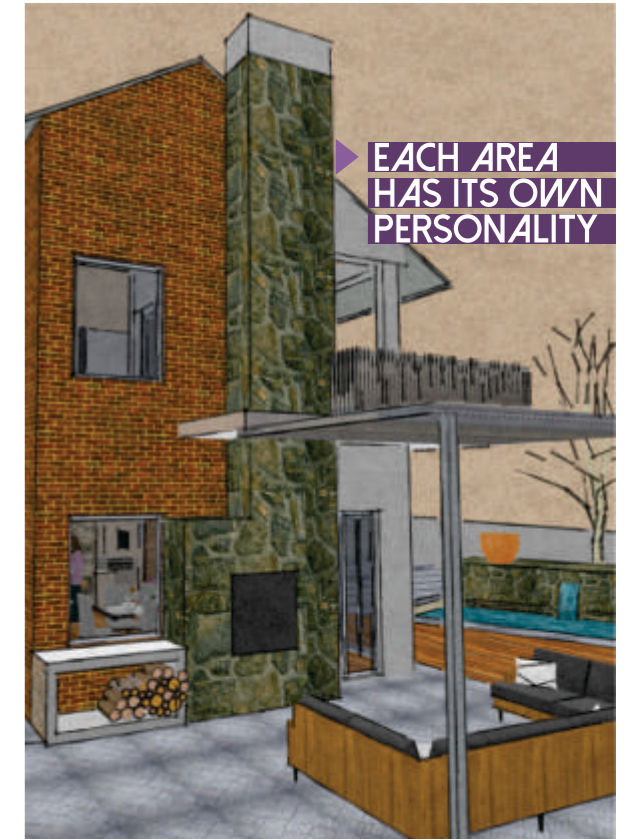

▶ EACH AREA HAS ITS OWN PERSONALITY

HOME DESIGN

08

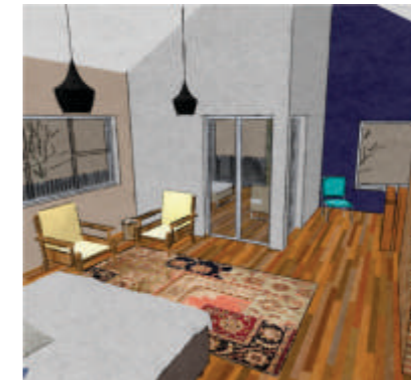

ENGELA VAN ANTWERPEN ARCHITECTS

Engela van Antwerpen, owner of EVA, was born in Pretoria and raised in the Free State. She is a dynamic and talented woman, goal orientated with a passion for natural structures & people. Her philosophy is that preparation and diligence is the key to success.

She completed her Bsc.(stud) degree at the University of the Free State and her Master's Degree, M.tech arch (prof) at TUT in Pretoria in Architecture in 2011. Since then she has worked at various firms to build up her accreditation and through SACAP qualified as an Architect.

Engela started her own firm EVA Architects in 2013, situated in Midstream Estate. EVA Architects works closely with their clients to ensure that the design aligns to the client's needs and are functional, safe and within the clients' budget. Keeping in mind the aesthetics and all the various new regulations, specifically surrounding green design regulations, standards and practices. Engela takes pride in her work and makes sure the clients are satisfied with everything from start to finish. Each design is unique to the stand and the environment and portrays that extra touch of the clients personality and taste.

MCL CONSTRUCTION

Michael spent the first eighteen years of his career in sales, marketing & management. Working for some of South Africa's leading international FMCG companies, such as Cadbury's, Beacon, Chico baby products & Johnson & Johnson. In 2001 he made the move into the construction industry. He began this phase of his career working for a project management company - Charterprops 37 Projects. His grounding as a project manager provided a solid foundation which allowed him to venture into MCL Construction. MCL Construction now trading as Goldsmith Lester Services, is recognized by the National Home Builders Registration Council. He prides himself on his ability to deliver quality projects. To set a standard in building through hard work, ethical practice, precision building & workmanship. To provide a service to his clients, by ensuring that houses are built on time with excellence and with the integrity that they deserve. To deliver quality service on time and at the convenience of his clients. To always use quality material, experienced & reliable sub-contractors, providing his clients with a home representative of their future & lifestyle.

CONTACT

▶ **Engela van Antwerpen**
www.eva-architects.co.za
Engela van Antwerpen
engela@eva-architects.co.za
082 721 9518

▶ **MCL Construction**
-
Michael Lester
mcllester@gmail.com
072 634 3783



THE HILLS
GAME RESERVE LIFESTYLE ESTATE
HOME DESIGN

08

SPONSORS



HOME DESIGN EXPO 2014

- ▶ **Corobrik**
www.corobrik.co.za
Nic Talbot
nic.talbot@corobrik.co.za
011 871 8600
- ▶ **Concentino**
www.silestone.com
Neil Sterley
nsterley@cosentino.com
083 276 4311
- ▶ **Kyasol**
www.kyasol.co.za
Jonathan Heck
jonathan@kyasol.co.za
011 840 0840
- ▶ **Envirodeck**
www.envirodeck.co.za
Warren Graver
info@envirodeck.co.za
011 615 7245
- ▶ **Mega Paints**
www.megapaintsptaeast.co.za
Kathleen Boshoff
kathleen@megapaintsm.co.za
012 480 0489
- ▶ **Victor Lidchi Carpets**
www.victorlidchi.co.za
Victor Lidchi
victor@victorlidchi.co.za
011 341 0367
- ▶ **Polyflor**
www.polyflor.co.za
Prema Charnock
20320837@polyflor.co.za
011 609 3500
- ▶ **Sutherlands**
www.shf.co.za
Hilton Tredgold
hiltont@shf.co.za
033 330 7225
- ▶ **Len-cha roof construction**
www.lencharoof.co.za
Len Ferreira
lencha@mweb.co.za
011 316 4351/3
- ▶ **Bosun**
www.bosun.co.za
Michele Trentelman
michelet@bosungroup.co.za
011 310 1176
- ▶ **Haasbroek & Boezaart Inc**
www.hblaw.co.za
Christine Gerber
gerbercp@hblaw.co.za
012 481 3555
- ▶ **Smartstone**
www.smartstone.co.za
Tania Venter
taniaV@smartstone.co.za
012 809 0471
- ▶ **Willow Feather Farm**
www.willowfeather.co.za
Francois Le Roux
francois@willowfeather.co.za
072 595 9342
- ▶ **Tru Outdoor Luxury**
www.truoudoorluxury.com
Collin Moodley
umhlanga@truoudoorluxury.com
031 584 7836



www.century.co.za

